

# OKSALIS FL 10

# OKSALIS FL 20

PRELIMINARY

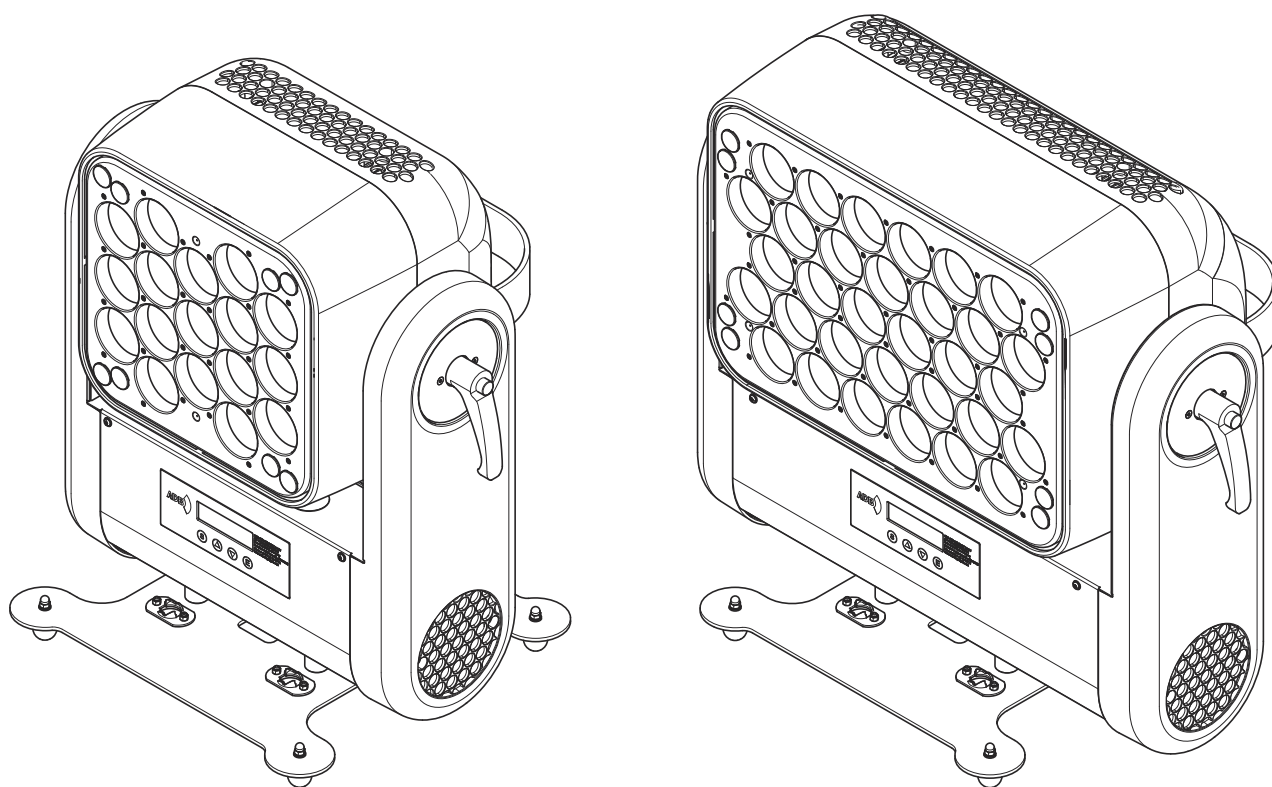

***Congratulations on choosing a ADB product! We thank you for your custom.***

*Please note that this product, as all the others in the rich ADB range, has been designed and made with total quality to ensure excellent performance and best meet your expectations and requirements.*

# INDEX

- 1. SAFETY INFORMATION**
- 2. UNPACKING AND PREPARATION**
- 3. INSTALLATION AND START-UP**
  - 3.1 Installing the fixture
  - 3.2 Connecting to main supply
  - 3.3 Connecting the control signal line: DMX / Art-Net
  - 3.4 Switching on the fixture and basic SetUp
- 4. MENU SETTING**
  - 4.1 SetUp Menu
  - 4.2 Option menu
  - 4.3 Information menu
  - 4.4 Manual Control Menu
  - 4.5 Test Menu
  - 4.6 Advanced Menu
- 5. DMX CHANNEL FUNCTIONS**
- 6. MAINTENANCE**
  - 6.1 Warning / Caution
  - 6.2 Periodical cleaning
  - 6.3 Battery removal
  - 6.4 Opening the covers
- 7. CAUSE AND SOLUTION OF PROBLEMS**
- 8. TECHNICAL DATA / SPECIFICATIONS**

# 1. SAFETY INFORMATION

**EN**

## **SAFETY INFORMATION**

IMPORTANT: Claypaky recommends you carefully read and keep the safety information on this product, also available in digital format at the following link:

**<https://www.adbstagelight.com/>**

Ref: [FIS00X - Safety Information Oksalis series]

**IT**

## **INFORMAZIONI DI SICUREZZA**

IMPORTANTE: Claypaky raccomanda di leggere accuratamente e conservare le informazioni di sicurezza relative a questo prodotto, sempre reperibili in versione digitale al seguente link:

**<https://www.adbstagelight.com/>**

Rif: [FIS00X - Safety Information Oksalis series]

**DE**

## **INFORMATIONEN ZUR SICHERHEIT**

WICHTIG: Claypaky empfiehlt, die Sicherheitsinformationen bezüglich dieses Produkts genau zu lesen und aufzubewahren. Sie sind in Digitalversion immer unter folgendem Link auffindbar:

**<https://www.adbstagelight.com/>**

Ref: [FIS00X - Safety Information Oksalis series]

**ES**

## **INFORMACIONES DE SEGURIDAD**

IMPORTANTE: Claypaky recomienda leer detenidamente y conservar la información de seguridad relativa a este producto. Además, está disponible una versión digital de la misma en el siguiente enlace:

**<https://www.adbstagelight.com/>**

Ref: [FIS00X - Safety Information Oksalis series]

**FR**

## **CONSIGNES DE SÉCURITÉ**

IMPORTANT: Claypaky recommande de lire attentivement et de conserver les informations de sécurité relatives à ce produit, disponibles en version digitale au lien suivant:

**<https://www.adbstagelight.com/>**

Réf. : [FIS00X - Safety Information Oksalis series]

**RU**

## **ИНСТРУКЦИЮ ПО ТЕХНИКЕ БЕЗОПАСНОСТИ**

ВАЖНО: Клаупаку рекомендует внимательно прочитать и сохранить инструкцию по технике безопасности данного изделия, которая всегда доступна в электронном формате по следующей ссылке:

**<https://www.adbstagelight.com/>**

Наименование: [FIS00X - Safety Information Oksalis series]

# 2. UNPACKING AND PREPARATION



Packing contents - Fig. 1

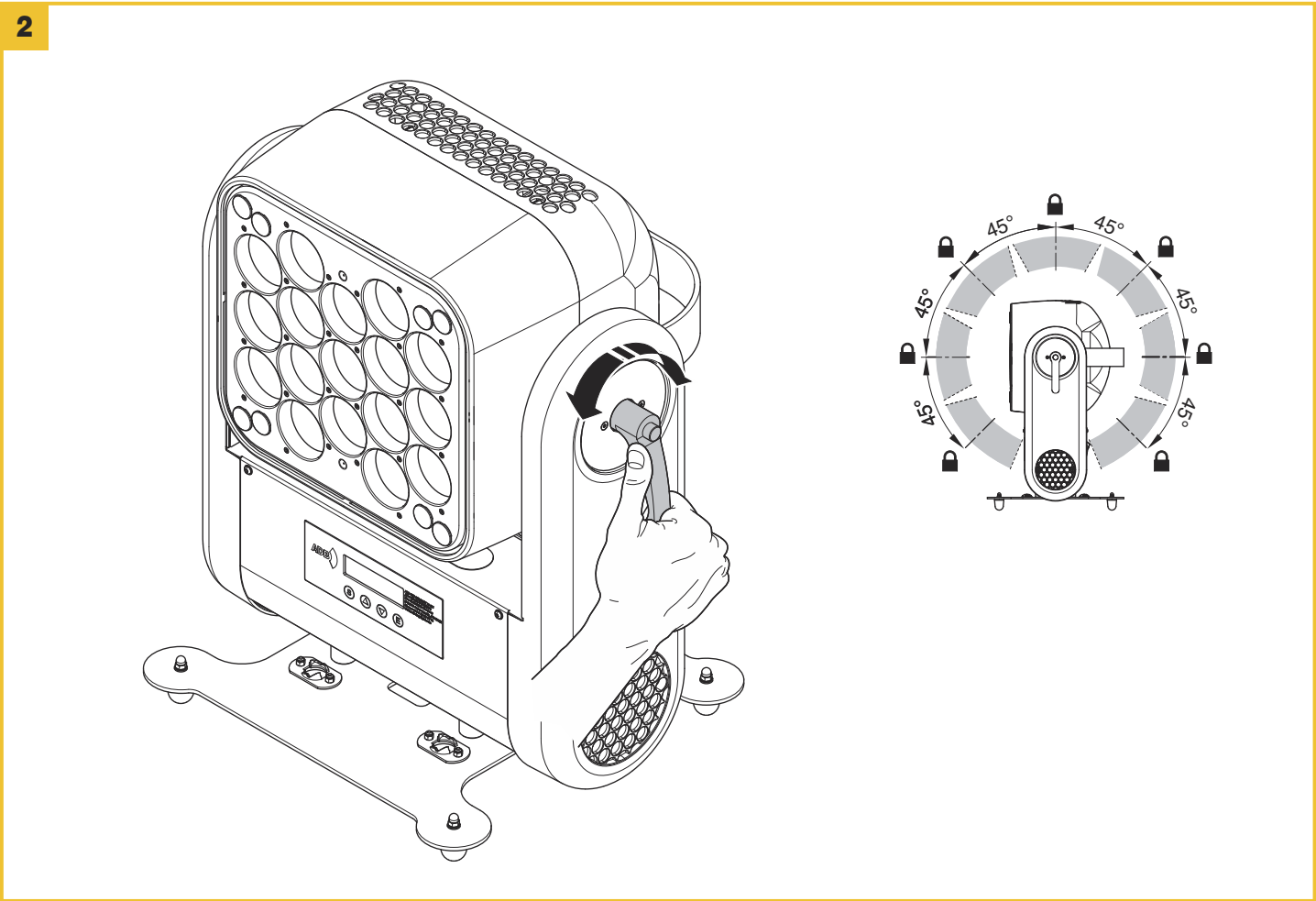

Head tilt adjustment - Fig. 2

## 3. INSTALLATION AND START-UP

### 3.1 Installing the fixture

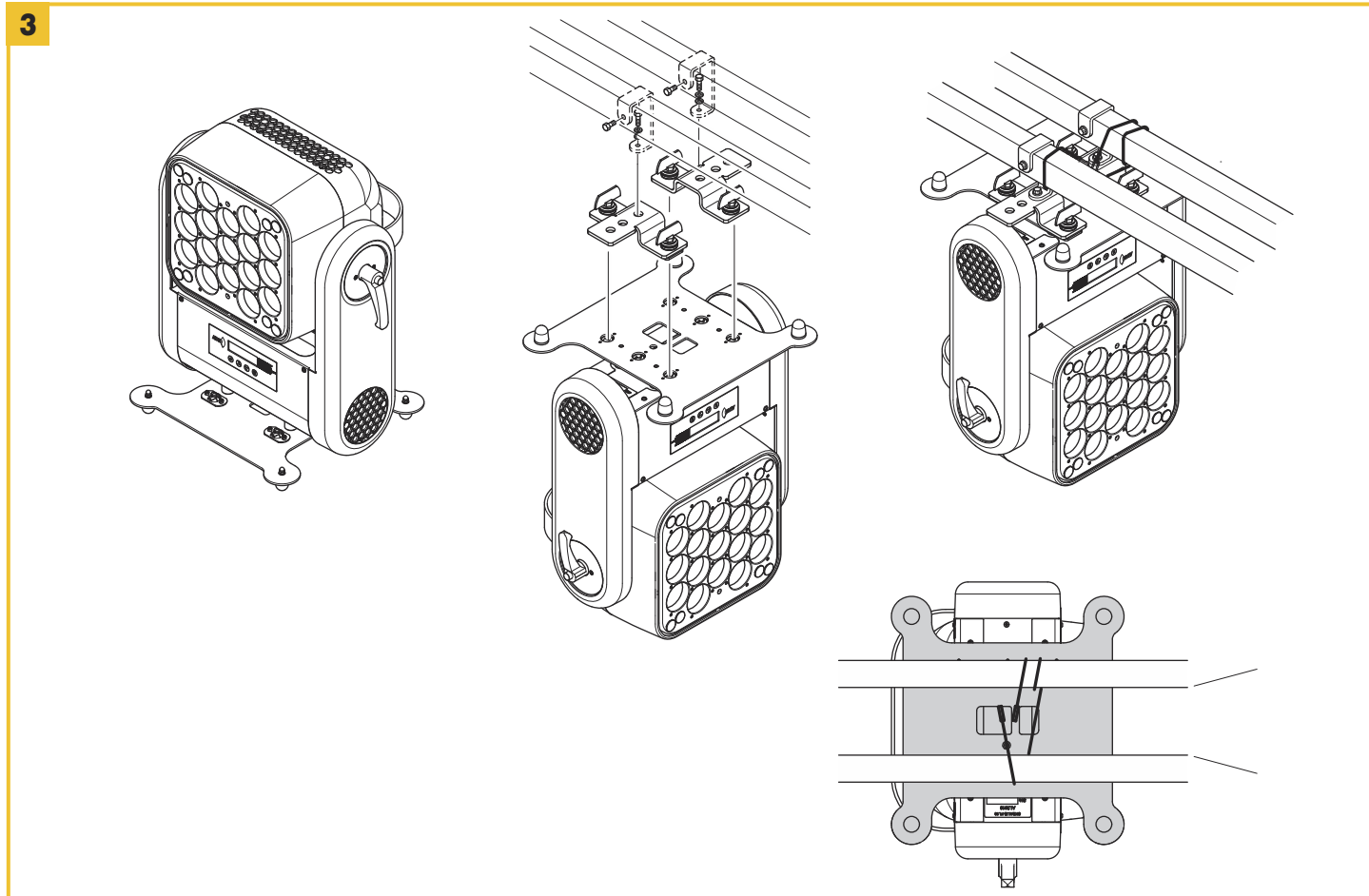

Installing the projector - Fig. 3

The projector can be installed on the floor resting on special rubber feet, on a truss or on the ceiling or wall.

**WARNING:** with the exception of when the projector is positioned on the floor, the safety cable must be fitted. (Cod. 105041/003 available on request). This must be securely fixed to the support structure of the projector and then connected to the fixing point at the centre of the base.

### 3.2 Connecting to mains supply

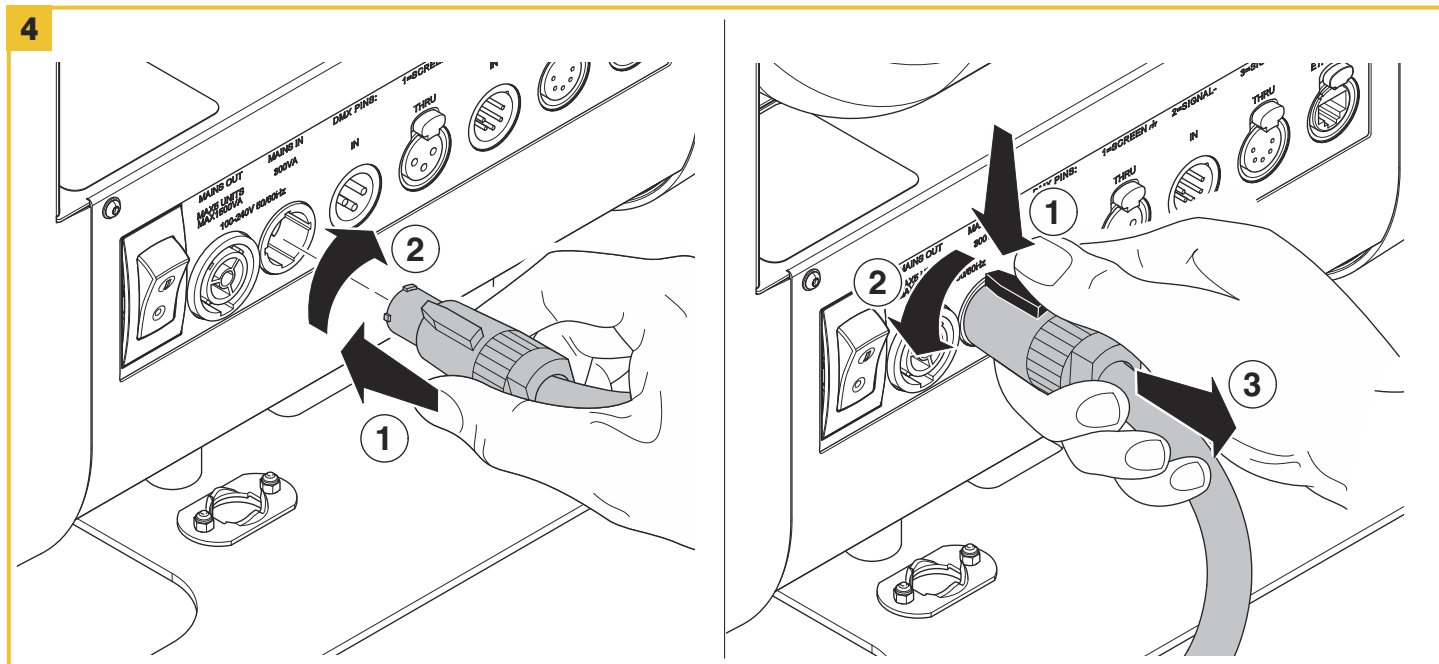

Connecting and disconnecting power cable - Fig. 4

5

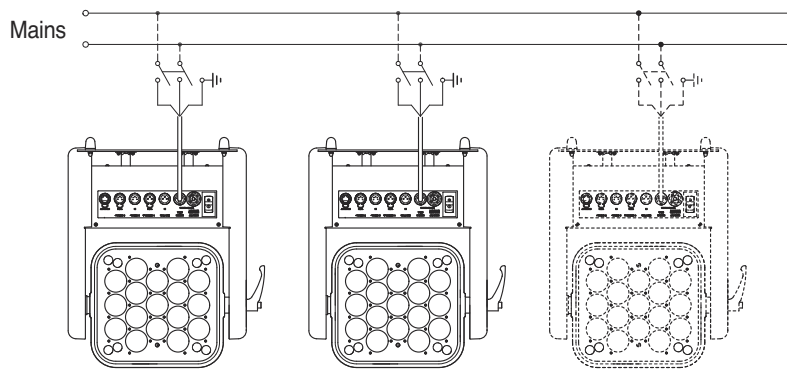

Connecting to the mains supply - Fig. 5

### 3.3 Connecting the control signal line: DMX / Art-Net

6

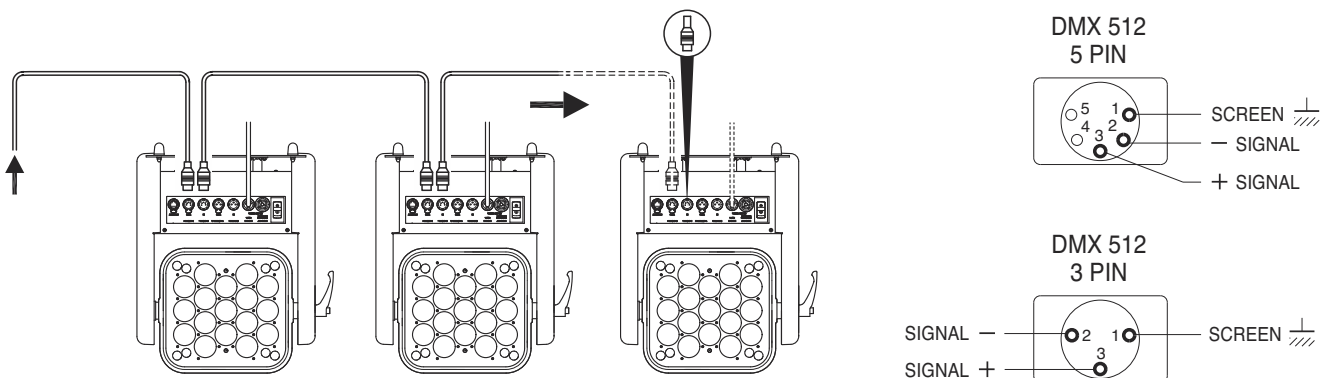

Connecting to the control signal line (DMX) - Fig. 6

Use a cable conforming to specifications EIA RS-485: 2-pole twisted, shielded, 120Ohm characteristic impedance, 22-24 AWG, low capacity. Do not use microphone cable or other cable with characteristics differing from those specified. The end connections must be made using XLR type 3/5-pin male/female connectors. A terminating plug must be inserted into the last projector with a resistance of 120Ohm (minimum 1/4 W) between terminals 2 and 3.

**IMPORTANT:** The wires must not make contact with each other or with the metal casing of the connectors. The casing itself must be connected to the shield braid and to pin 1 of the connectors.

### 3.4 Switching on the fixture and basic SetUp

7

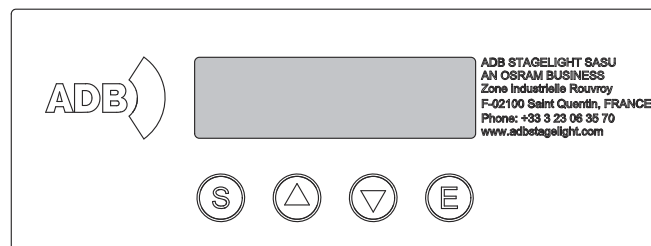

Switching on the projector - Fig. 7

Press the switch. The projector starts resetting the effects. At the same time, the following information scrolls on the display:

	<b>Model</b> Oksalis	<b>Firmware</b> Version X.X.X <b>Date - Hour</b>	<b>xxx (Fixture ID)</b> <b>Dmx Address xxx</b>	<b>System errors</b> <b>E:</b> ..... <b>W:</b> .....
--	-------------------------	--	---	--

The control panel (Fig. 7) has a display and buttons for the complete programming and management of the projector menu.

The display can be in one of two conditions: rest status and setting status. When it is in the rest status, the display shows the projector's DMX address and the Fixture ID address (if set).

During menu setting status, after a wait time (about 30 seconds) without any key having been pressed, the display automatically returns to rest status. It should be noted that when this condition occurs, any possible value that has been modified but not yet confirmed with the  $\otimes$  key will be cancelled.

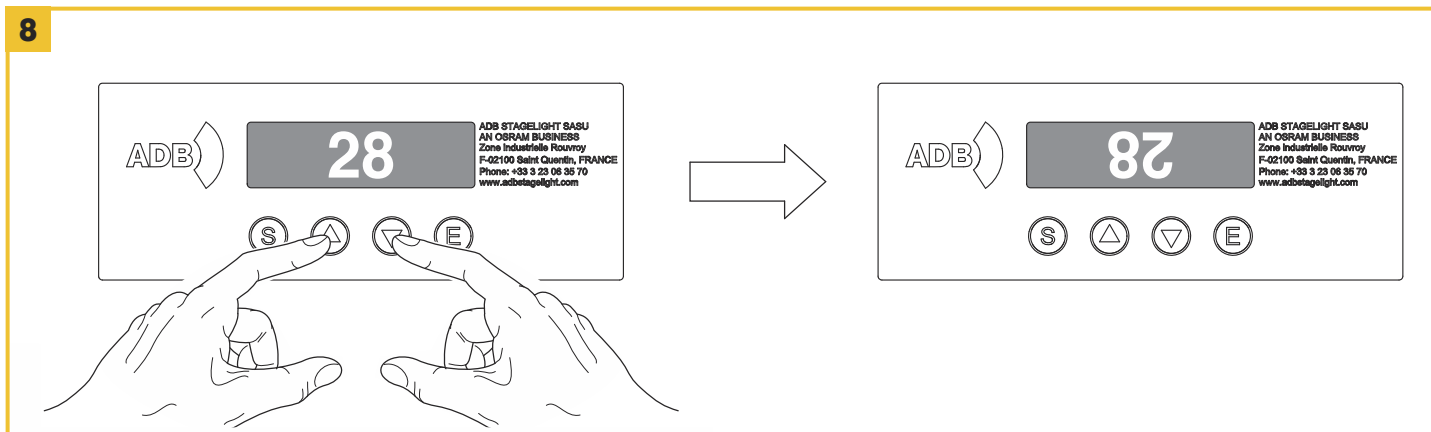

#### Reversal of the display - Fig. 8

To activate this function, press UP and DOWN keys simultaneously while the display is in the rest mode. This status will be memorised and maintained even for the next time it will be switched on. To return to the initial state, repeat the operation all over again.

#### Setting the projector starting address

On each projector, the starting address must be set for the control signal (addresses from 1 to 512).

The address can also be set with the projector switched off.

#### Setting the projector Fixture ID

On each projector, the Fixture ID address must be set for an easy identification of the fixtures in an installation (ID from 1 to 255).

The Fixture ID address can be set with the projector switched off.

### Button functions – Menu SET

<b>SELECT</b> 	<ul style="list-style-type: none"> <li>• <b>If pressed in idle status:</b> Cyclically switches between idle status and menu settings.</li> <li>• <b>If pressed while setting a menu:</b> Moves to an upper level without changing anything (exits the function)</li> </ul>
<b>DOWN</b> 	Decreases the value displayed (with auto-repetitions), or passes to the next item on the menu For quick access to the minimum parameter value, press the UP key while holding down the DOWN key.
<b>UP</b> 	Increases the value displayed (with auto-repetitions), or passes to the previous item on the menu For quick access to the maximum parameter value, press the DOWN key while holding down the UP key.
<b>ENTER</b> 	Confirms the displayed value or activates the displayed function or opens the next menu.

#### Setting addresses and options with the projector disconnected

The projector's DMX address, as well as other possible operating options, can also be set when the appliance is disconnected from the electricity supply. All that is needed is to press any key to momentarily activate the display and thus access the settings. Once the required operations have been carried out, the display will switch off again after a wait time of 30 seconds.

# 4. MENU SETTING



## 5. DMX CHANNEL FUNCTIONS

## 6. MAINTENANCE

### 6.1 Warning / Caution

- To avoid damage to the internal parts of the fixture when the fixture is not working, is recommended to turn the head down before turning the fixture off, so that the front lenses of the fixture are invested as little as possible from the sun.
- Set Zoom channel to 255-bit before turning off the projector to facilitate the packaging of the projector.
- It is recommended not to use compressed air with more than 4 atmospheres for cleaning the internal parts of the fixture, led board area. This is to avoid damaging electronic components.

9



#### Light collimation system

This product contains internal light collimation system. Avoid intense light from any angle.

**WARNING:**  
no alcohol

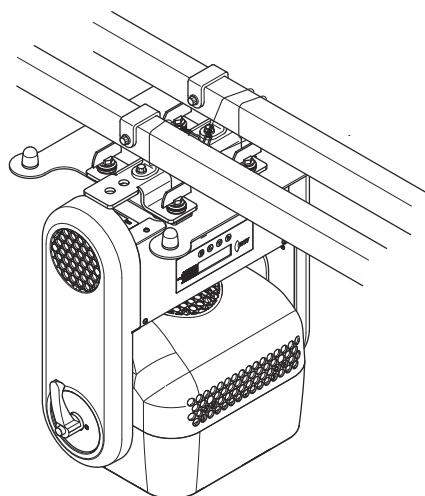
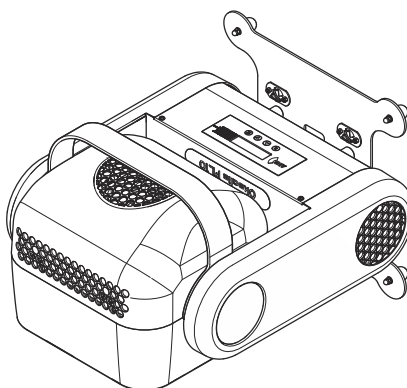
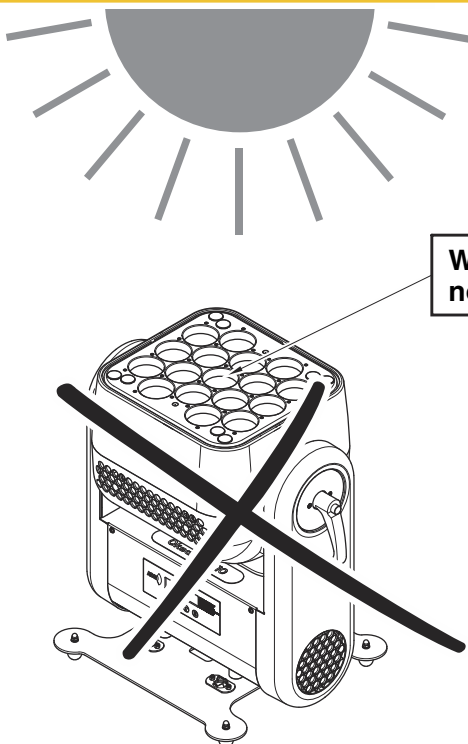
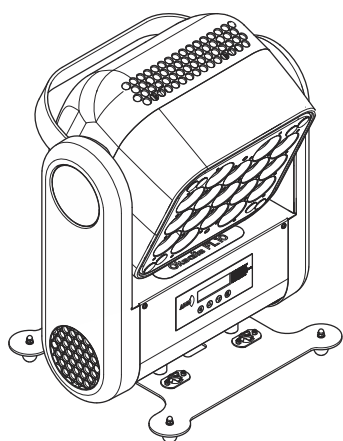

### 6.2 Periodical cleaning

- To ensure optimal operation and performance for a long time it is essential to periodically clean the parts subject to dust and grease deposits. The frequency with which the following operations are to be carried out depends on various factors, such as the amount of the effects and the quality of the working environment (air humidity, presence of dust, salinity, etc.).

It is recommended that the projector undergoes an annual service by a qualified technician for special maintenance involving at least the following operations:

- General cleaning of internal parts.
- Restoring lubrication of all parts subject to friction, using lubricants specifically supplied by Claypaky.
- General visual check of the internal components, cabling, mechanical parts, etc.
- Electrical, photometric and functional checks; eventual repairs.

#### Cleaning the lenses

Only use neutral soap and water to clean the lenses, then dry it carefully with a soft, non-abrasive cloth. (WARNING: the use of alcohol or any other detergent could damage the lenses).

## 6.3 Battery removal

10

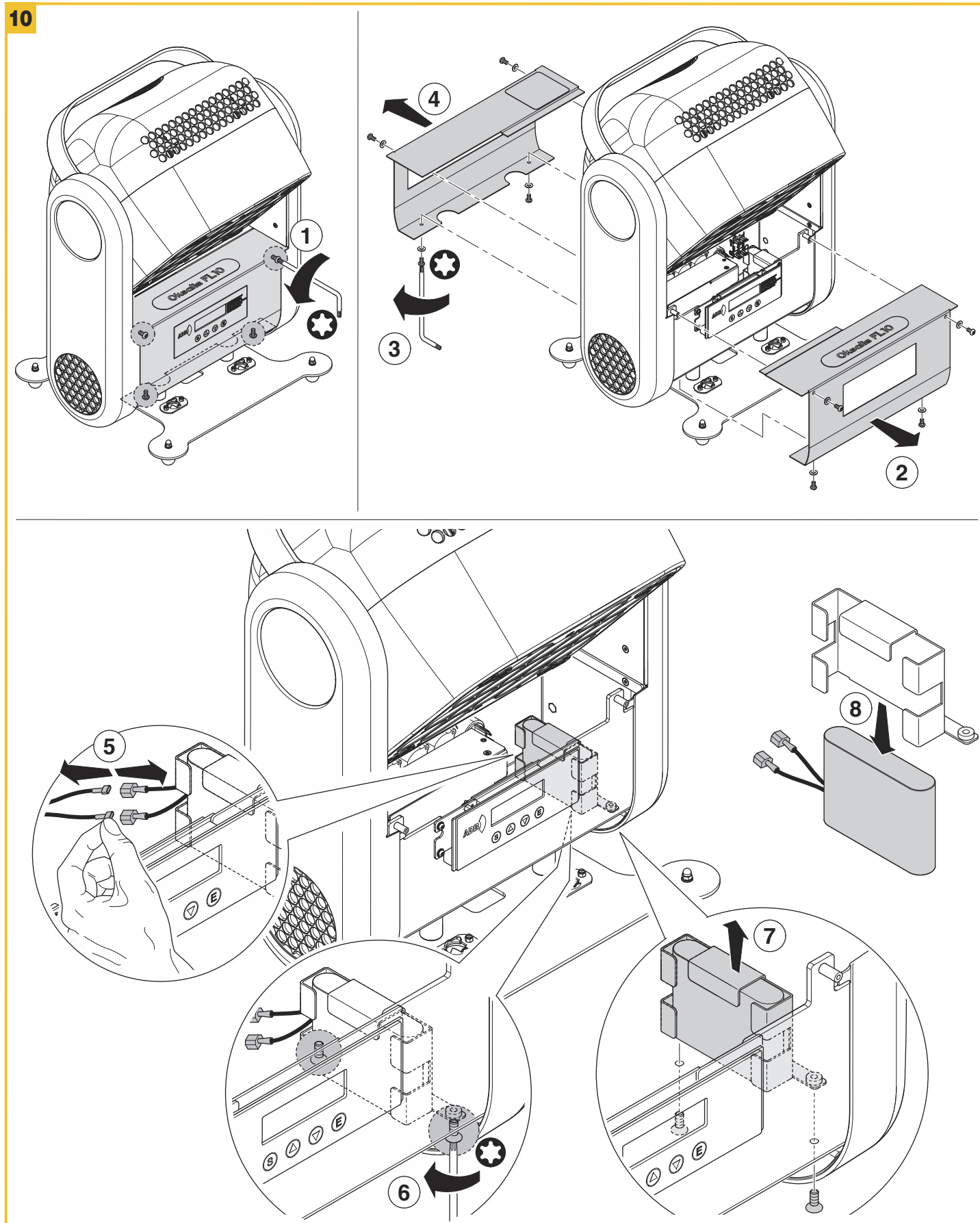

Battery removal - Fig. 10



This product contains a rechargeable battery. To preserve the environment, please dispose the battery at the end of its life according to the regulation in force.

## 6.4 Opening the covers

11

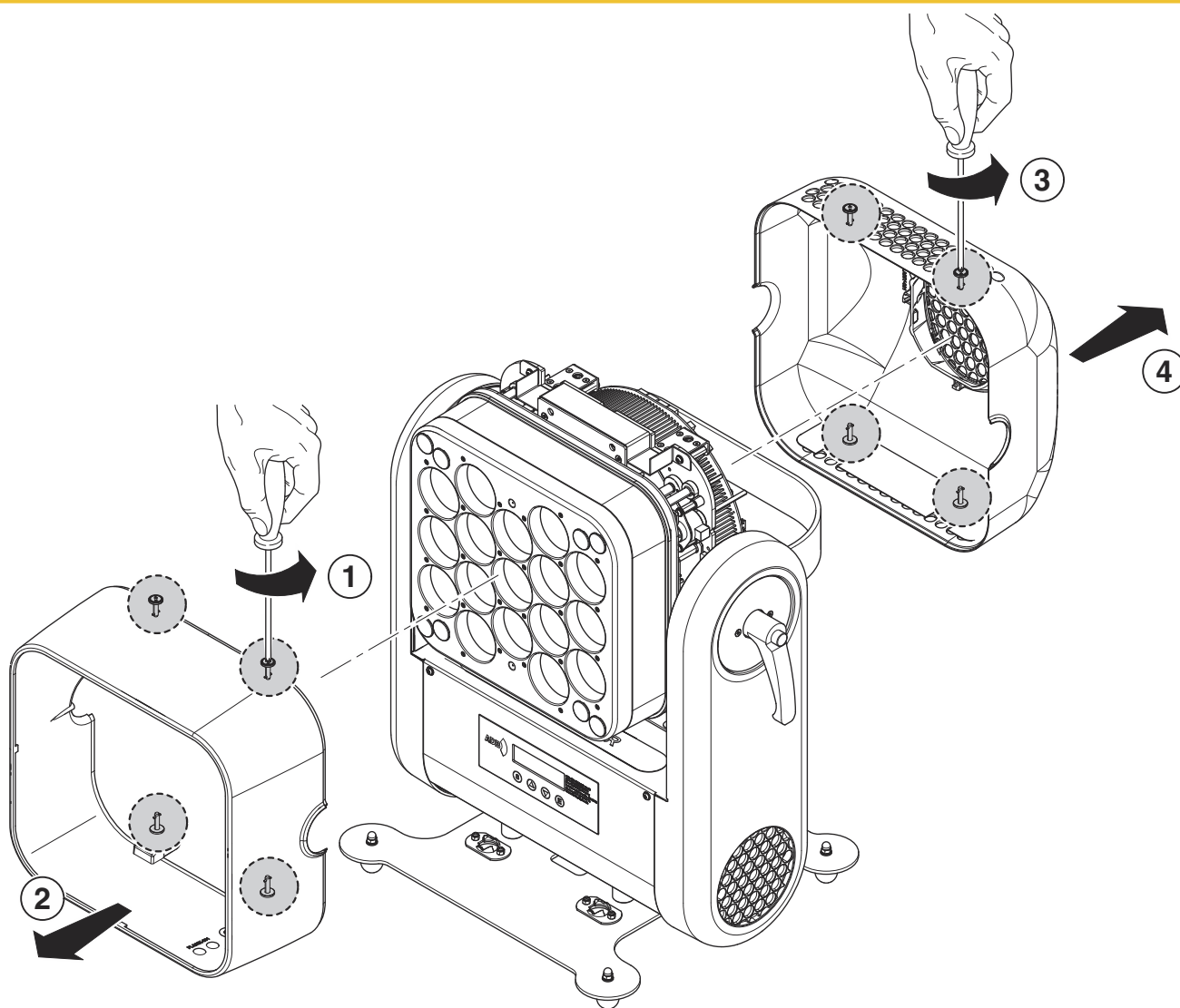

Opening the covers - Fig. 11

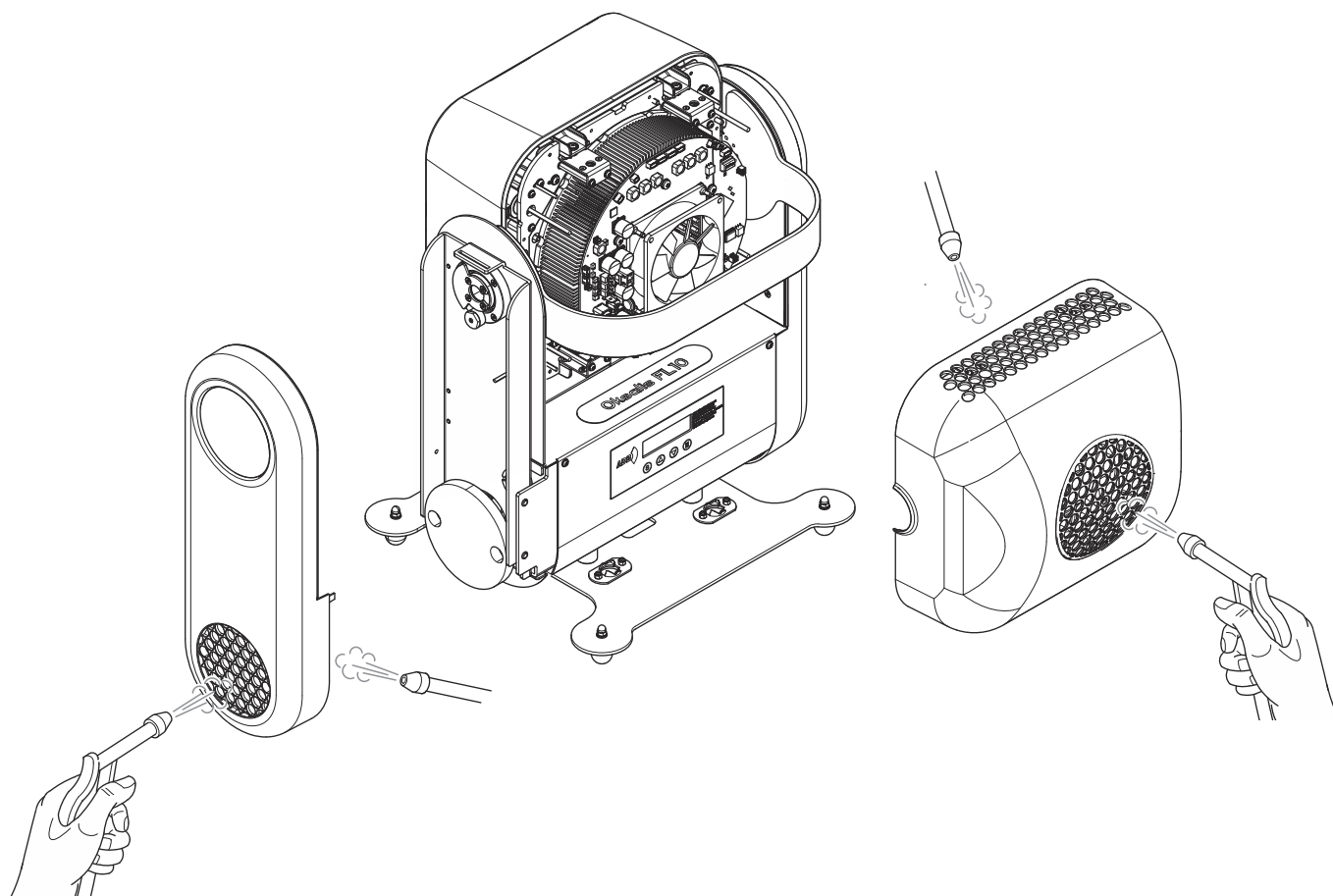
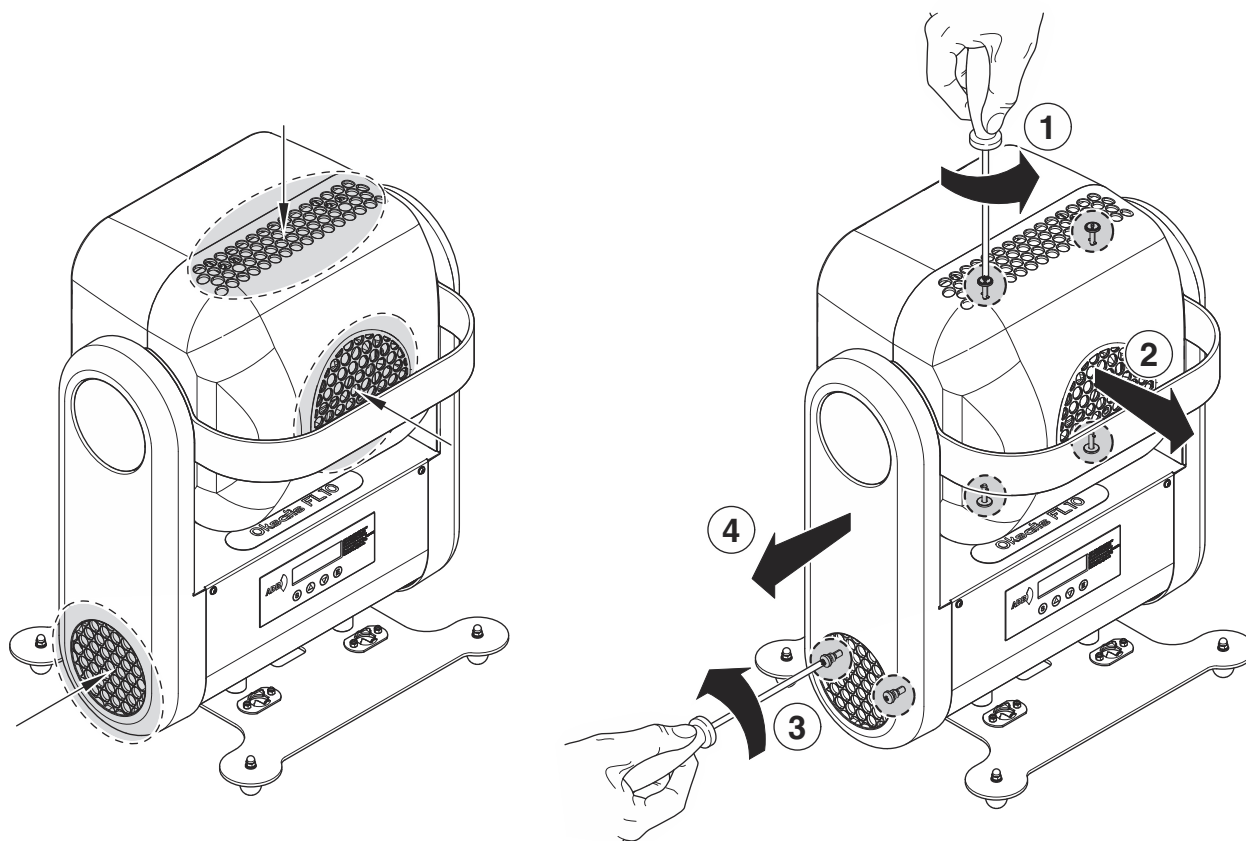

Cleaning of the filters - Fig. 12

# 7. CAUSE AND SOLUTION OF PROBLEMS

THE PROJECTOR WILL NOT SWITCH ON				PROBLEMS
ELECTRONICS NON-OPERATIONAL				
DEFECTIVE PROJECTION				
REDUCED LUMINOSITY				
POSSIBLE CAUSES				CHECKS AND REMEDIES
●			No mains supply.	Check the power supply voltage.
●		●	LED exhausted or defective.	Call an authorised technician.
	●		Signal transmission cable faulty or disconnected.	Replace the cables.
	●		Incorrect addressing.	Check addresses (see instructions).
	●		Fault in the electronic circuits.	Call an authorised technician.
	●		Lenses broken	Call an authorised technician.
		● ●	Dust or grease deposited.	Clean (see instructions).

# 8. TECHNICAL DETAILS / SPECIFICATIONS

## OKSALIS FL 10

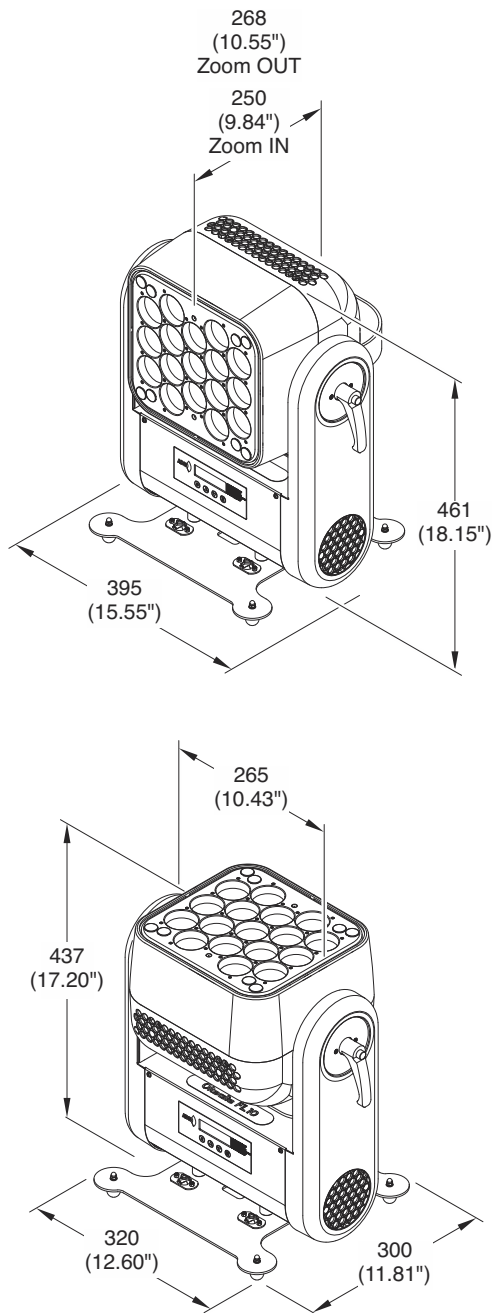

### POWER SUPPLIES

100/240V 50/60 Hz

### INPUT POWER

300VA

### LIGHT SOURCE

Light sources: 6-color LED modules  
LED module: R+G+B+Amber+Cyan+Lime  
Number of LEDs: 17  
LED life expectancy: min. 50,000h  
Typical lumen maintenance: 70% @ 50,000 hours  
Typical CRI value > 97 up to 99

### OPTICS

Optics featuring 6-color LED module system + rod-bar mixing system + front lens  
6°- 50° linear electronic Zoom

### COLOR SYSTEM

Color system: R+G+B+Cyan+Amber+Lime LED module  
Color Temperature control: Linear from 2500K to 8000K (CTO controlled mode plus RAGCB correction)  
Control of the colors: RAW mode, HSL mode, RGB mode, CMY mode  
- RAW mode Enable specific control of each color  
- HSL mode function is based on algorithm. HSL parameters: HUE, HUE fine, Saturation, Crossfade, Path, Tint  
- RGB mode The projectors work in the same way as a classical RGB fixture  
- CMY mode The projectors work in the same way as a classical CMY fixture  
Halo Emulation 750W, 1000W, 1200W, 2000W, 2500W lamp emulation  
Gamma Wave: Different chromatic curves for each color  
Macro: Dedicated color macro channel with 80 preselected colors

### EFFECTS SECTION

Electronic and linear dimmer, 16 bit  
Strobe 24 flash/sec. Electronic, instant open and blackout. Variable speed pulsation

### CONTROL AND PROGRAMMING

27 DMX 512 control channels  
Control signal: USITT DMX 512  
Protocols: RDM, WebServer and Art-Net  
Display: Graphic LCD backlit b/w display  
Display battery: Long life self-charging buffer battery  
Pan/Tilt Resolution 16 bit  
Dimmer Resolution 16 bit

Movement control: vectorial

DMX signal connection: 3 and 5 pole XLR input and output

Firmware update: Software upload through DMX input

### BODY

Structure in aluminium with die-cast plastic cover  
Optional frame for external gels and frost filters  
Optional top hat (adjustable with the Zoom movement)

### ELECTRONICS

Long-life auto-charging buffer battery  
Preset color and graphic effect macros  
Function reset controllable from a central control unit  
Menu-driven internal self-test function  
Electronic check-up of every single parameter with error alarm  
DMX level monitoring on each channel  
Automatic internal data transmission error diagnostics  
Firmware upgrade with no power  
Firmware transfer from one light to another

### SAFETY DEVICES

Minimum distance of illuminated objects: 0.2 meters (8")  
Minimum distance from flammable materials: 0.2 meters (8")  
Max ambient temperature: 40°C (104°F)  
Max temperature of the external surface: 90°C (194°F)  
Bipolar circuit breaker with thermal protection  
Automatic break in power supply in case of overheating  
Forced ventilation with axial fans

### CE MARKING

In conformity with the European Directives:  
• 2014/35/EU - Safety of electrical equipment supplied at low voltage (LVD)  
• 2014/30/EU - Electromagnetic Compatibility (EMC)  
• 2011/65/EU - Restriction of the use of certain hazardous substances (RoHS)  
• 2009/125/EC - EcoDesign requirements for Energy-related Products (ErP)

### WEIGHT

12 Kg (26.45 lbs)



## OKSALIS FL 20

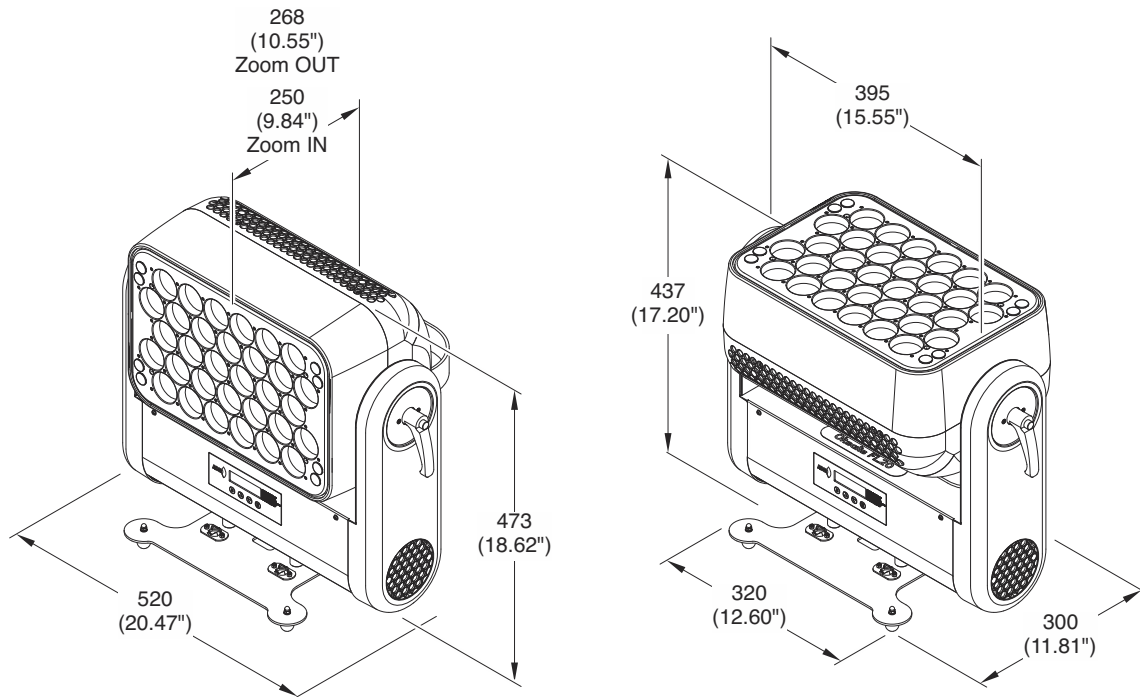

### POWER SUPPLIES

100/240V 50/60 Hz

### INPUT POWER

500VA

### LIGHT SOURCE

Light sources: 6-color LED modules  
LED module: R+G+B+Amber+Cyan+Lime  
Number of LEDs: 32  
LED life expectancy: min. 50,000h  
Typical lumen maintenance: 70% @ 50,000 hours  
Typical CRI value > 97 up to 99

### OPTICS

Optics featuring 6-color LED module system + rod-bar mixing system + front lens  
6° - 50° linear electronic Zoom

### COLOR SYSTEM

Color system: R+G+B+Cyan+Amber+Lime LED module  
Color Temperature control: Linear from 2500K to 8000K (CTO controlled mode plus RAGCB correction)  
Control of the colors: RAW mode, HSL mode, RGB mode, CMY mode  
- RAW mode Enable specific control of each color  
- HSL mode function is based on algorithm. HSL parameters: HUE, HUE fine, Saturation, Crossfade, Path, Tint  
- RGB mode The projector works in the same way as a classical RGB fixture  
- CMY mode The projector works in the same way as a classical CMY fixture  
Halo Emulation 750W, 1000W, 1200W, 2000W, 2500W lamp emulation  
Gamma Wave: Different chromatic curves for each color  
Macro: Dedicated color macro channel with 80 preselected colors

### EFFECTS SECTION

Electronic and linear dimmer, 16 bit  
Strobe 24 flash/sec. Electronic, instant open and blackout. Variable speed pulsation

### CONTROL AND PROGRAMMING

27 DMX 512 control channels  
Control signal: USITT DMX 512  
Protocols: RDM, WebServer and Art-Net  
Display: Graphic LCD backlit b/w display  
Display battery: Long life self-charging buffer battery  
Pan/Tilt Resolution 16 bit  
Dimmer Resolution 16 bit  
Movement control: vectorial  
DMX signal connection: 3 and 5 pole XLR input and output  
Firmware update: Software upload through DMX input

### BODY

Structure in aluminium with die-cast plastic cover  
Optional frame for external gels and frost filters  
Optional top hat (adjustable with the Zoom movement)

### ELECTRONICS

Long-life auto-charging buffer battery  
Preset color and graphic effect macros  
Function reset controllable from a central control unit  
Menu-driven internal self-test function  
Electronic check-up of every single parameter with error alarm  
DMX level monitoring on each channel  
Automatic internal data transmission error diagnostics  
Firmware upgrade with no power  
Firmware transfer from one light to another

### SAFETY DEVICES

Minimum distance of illuminated objects: 0.2 meters (8")  
Minimum distance from flammable materials: 0.2 meters (8")  
Max ambient temperature: 40°C (104°F)  
Max temperature of the external surface: 90°C (194°F)  
Bipolar circuit breaker with thermal protection  
Automatic break in power supply in case of overheating  
Forced ventilation with axial fans

### CE MARKING

In conformity with the European Directives:  
• 2014/35/EU - Safety of electrical equipment supplied at low voltage (LVD)  
• 2014/30/EU - Electromagnetic Compatibility (EMC)  
• 2011/65/EU - Restriction of the use of certain hazardous substances (RoHS)  
• 2009/125/EC - EcoDesign requirements for Energy-related Products (ErP)

### WEIGHT

17 Kg (37.48 lbs)