



# Sharp X Frame

## Sharp X Frame FD

CD3003

Datasheet  
06/2025

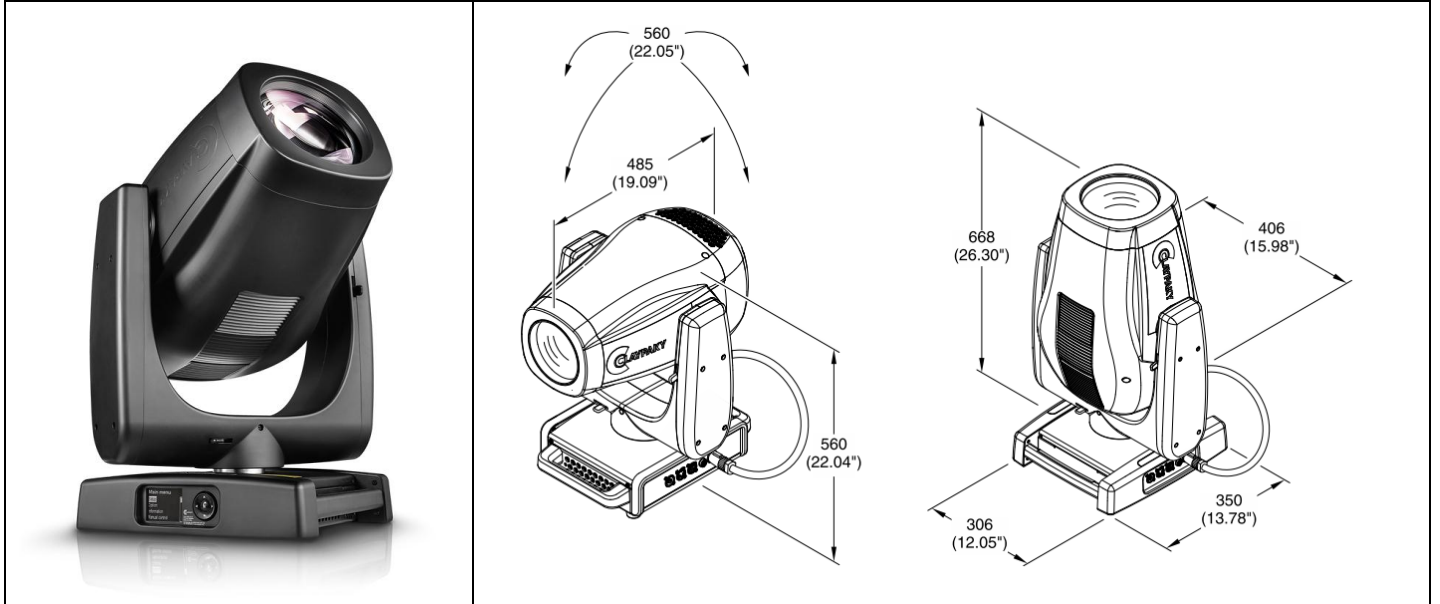

### LIGHT SOURCE TYPE

- Philips 25R 550W lamp
- CRI: 80+
- Colour Temperature: 8000K
- Lamp life expectancy: 1500 hrs

*\*It may vary depending on various factors, as type of use and environment*

### PHOTOMETRIC DATA

- Zoom range: 3° to 52° (Spot mode) – 2° to 29° (Beam mode)
- 18800 Lumen Output (Integrating Sphere)
- Front lens diameter: 160mm
- High efficiency optical system

### NOISE LEVEL

- Auto fan mode: 49.3 dBA

### CONTROL and CONNECTIONS

- Personalities: Single mode with 43 control channels
- Control Protocol: DMX, Art-Net, RDM, sACN
- DMX and RDM connectors: Locking 5 pin XLR IN/THRU
- Ethernet port: RJ45 IN
- Power connector: PowerCon True1
- Built In Web Server



# Sharpy X Frame

## Sharpy X Frame FD

CD3003

Datasheet  
06/2025

### DYNAMIC EFFECTS

- Colours:
  - Linear CMY colour mixing (brilliant and lighter Magenta in the **Sharpy X Frame FD** model)
  - Linear CTO
  - Fixed color wheel with 14 dichroic colors
- Gobos:
  - 1 Rotating gobo wheel with 8 HD Indexable and replaceable gobos  
Rotating gobo dimensions:  
Ext diam. 19 mm  
Image diam. 13.5 mm  
Thickness 1.1mm
  - 1 Static Gobo Wheel with 18 gobos
- Framing system:
  - 4 blades with +/- 60° rotation of the full system
  - "Total Curtain" effect allowing the full blackout with each single blade
  - Built In macros
- Frost:
  - Linear heavy frost 5° for wash effect **Sharpy X Frame**
  - Linear light frost 2° for wash effect **Sharpy X Frame FD**
- Rotating Effects
  - Aluminum animation wheel with continuous rotation in both direction at variable speed
  - 2 prisms (4 and 8 facet) with rotation in both direction at variable speed
- Iris:
  - Motorized with variable pulse and random effects
- Movement:
  - Tilt: 270° - 16bit
  - Pan: 540° - 16bit
  - Accuracy: Resolution  $\pm 0.27^\circ$  (Range 0.54°)
  - Automatic repositioning
  - Fast/Standard speed selectable by Function channel
  - Mechanical Pan/Tilt lock for safe transportation and maintenance
- Beam:
  - Motorized Zoom and Focus
- Dimmer/Shutter :
  - High resolution dimmer 16 bit
  - Shutter and Strobe effect

### HARDWARE and SOFTWARE

- Long life self-charging battery
- Display Graphic LCD backlit b/w Display
- Firmware upload from another fixture
- Firmware Upgrade via Web Server
- Diagnostic
- DMX monitoring
- Remote access through RDM
- CloudIO compatibility



# Sharpy X Frame Sharpy X Frame FD CD3003

Datasheet  
06/2025

## **HOUSING**

- Aluminum and steel structure with plastic covers
- Two side handles for transportation
- IP20 protection rate

## **WORKING POSITION**

- Working in any position
- Hanging system: with fast-lock omega clamps (1/4 turn) on the base
- Optional safety chain

## **ELECTRICAL**

- Operating Voltage: 100-240V, 50/60 Hz
- Power Supply: Electronic auto range with active PFC
- Max Power consumption: 750VA

## **THERMAL SPECIFICATION**

- Max ambient temperature 45°C (113°F)
- Min ambient temperature -20°C (-4°F)
- Max temperature of the external surface 90°C (194°F)
- Total heat dissipation: 2562 BTU/hr  $\pm 10\%$  / 2700 kJ/hr  $\pm 10\%$

## **SAFETY SPECS**

- Minimum distance of illuminated objects 8 meters (26' 3")
- Minimum distance from flammable materials 0.2 meters (8")
- Fuse T10A – 250V
- Thermally protected power supply (overheating and cooling failure)
- Forced ventilation with axial fans

## **COMPLIANCE**

- CE: conforms to the European Directives
- UKCA: conforms to UK Regulations
- EAC: conforms to EurAseC Regulations
- cMETus Listed

## **PACKAGING**

- Carton box + Polystyrene
- Carton box + Foam shell
- Flight case + Foam shell (2 positions)

## **WEIGHT - SIZE**

- 28 Kg (61.7 lbs)
- 306x350mm (base dimension) – 668 with vertical head (h)
- Distance between two fixtures 505mm



# Sharpy X Frame Sharpy X Frame FD

CD3003

Datasheet  
06/2025

## **ACCESSORIES**

- Omega clamps: 2x183102/805 (included)
- Power cord: CAB02B/802 (included)
- Foam shell: F21326/001 (optional)
- Flight case 2 positions: CF1006 (optional)
- Safety Chain: 105041/003 (optional)
- "SharpyX-Frame" to "SharpyX-Frame-FD" conversion kit: CA3005000102 (optional)
- "SharpyX-Frame-FD" to "SharpyX-Frame" conversion kit: CA3006000102 (optional)
- "SharpyX-Frame" to "SharpyX-Spot" conversion kit: CA3011000100 (optional)